

NORTH JOHNSON AVE

FLETCHER PKWY

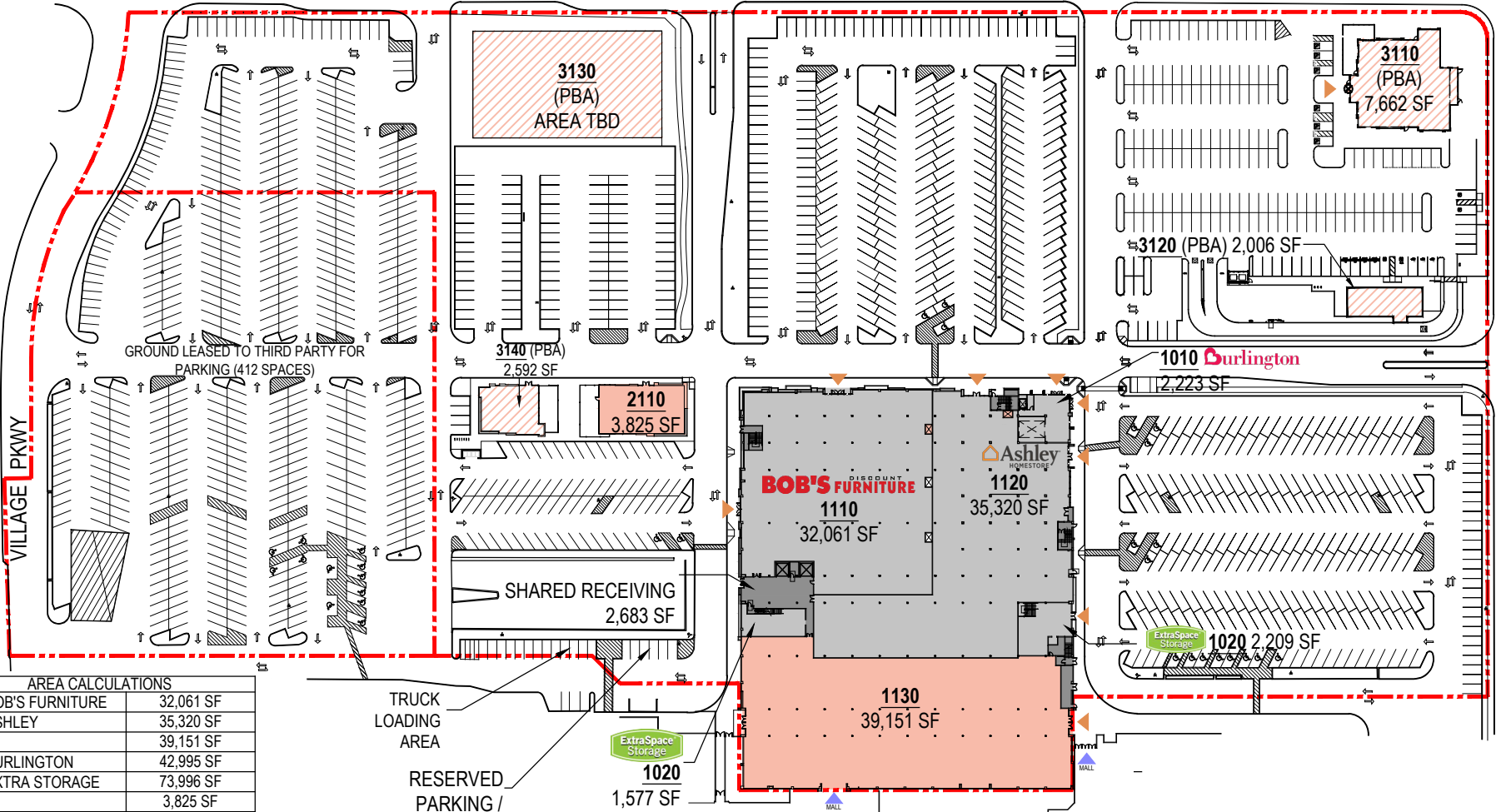

AREA CALCULATIONS	
1110 BOB'S FURNITURE	32,061 SF
1120 ASHLEY	35,320 SF
1130	39,151 SF
1010 BURLINGTON	42,995 SF
1120 EXTRA STORAGE	73,996 SF
2110	3,825 SF
3110	7,662 SF
3120	2,006 SF
3130	TBD
3140	2,592 SF
TOTAL	239,609 SF
PARKING (APPROX.)	1,027 SPACES
PARKING RATIO	1 PER 233 SF
	4.3 PER 1,000 SF

AVAILABLE
 LEASED
 PROPOSED

NOTE: THIS CONCEPTUAL SITE PLAN IS FOR PLANNING PURPOSES ONLY. SITE SPECIFIC INFORMATION SUCH AS EXISTING CONDITIONS, ZONING, PARKING, LANDSCAPE AND EGRESS REQUIREMENTS MUST BE VERIFIED BY ZONING ATTORNEY AND CODE CONSULTANT. LOCATIONS OF MECHANICAL SHAFTS ARE TO BE DETERMINED. STAIRS ARE FOR ILLUSTRATIVE PURPOSES ONLY AND TO BE REVISED TO MEET EGRESS REQUIREMENTS.

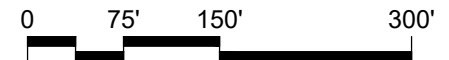

SCALE: 1" = 150'-0"



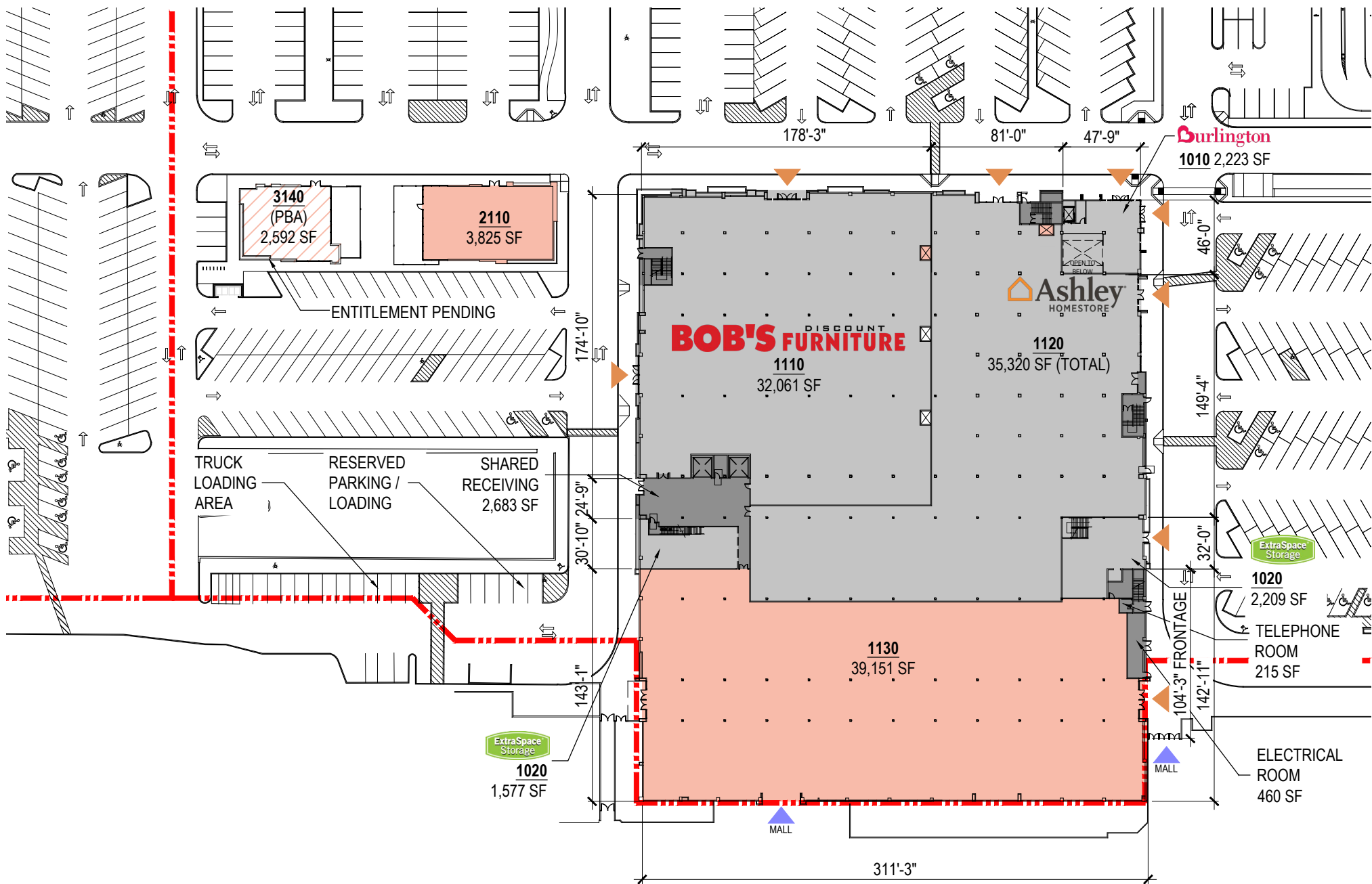

NOTE: THIS CONCEPTUAL SITE PLAN IS FOR PLANNING PURPOSES ONLY. SITE SPECIFIC INFORMATION SUCH AS EXISTING CONDITIONS, ZONING, PARKING, LANDSCAPE AND EGRESS REQUIREMENTS MUST BE VERIFIED BY ZONING ATTORNEY AND CODE CONSULTANT. LOCATIONS OF MECHANICAL SHAFTS ARE TO BE DETERMINED. STAIRS ARE FOR ILLUSTRATIVE PURPOSES ONLY AND TO BE REVISED TO MEET EGRESS REQUIREMENTS.

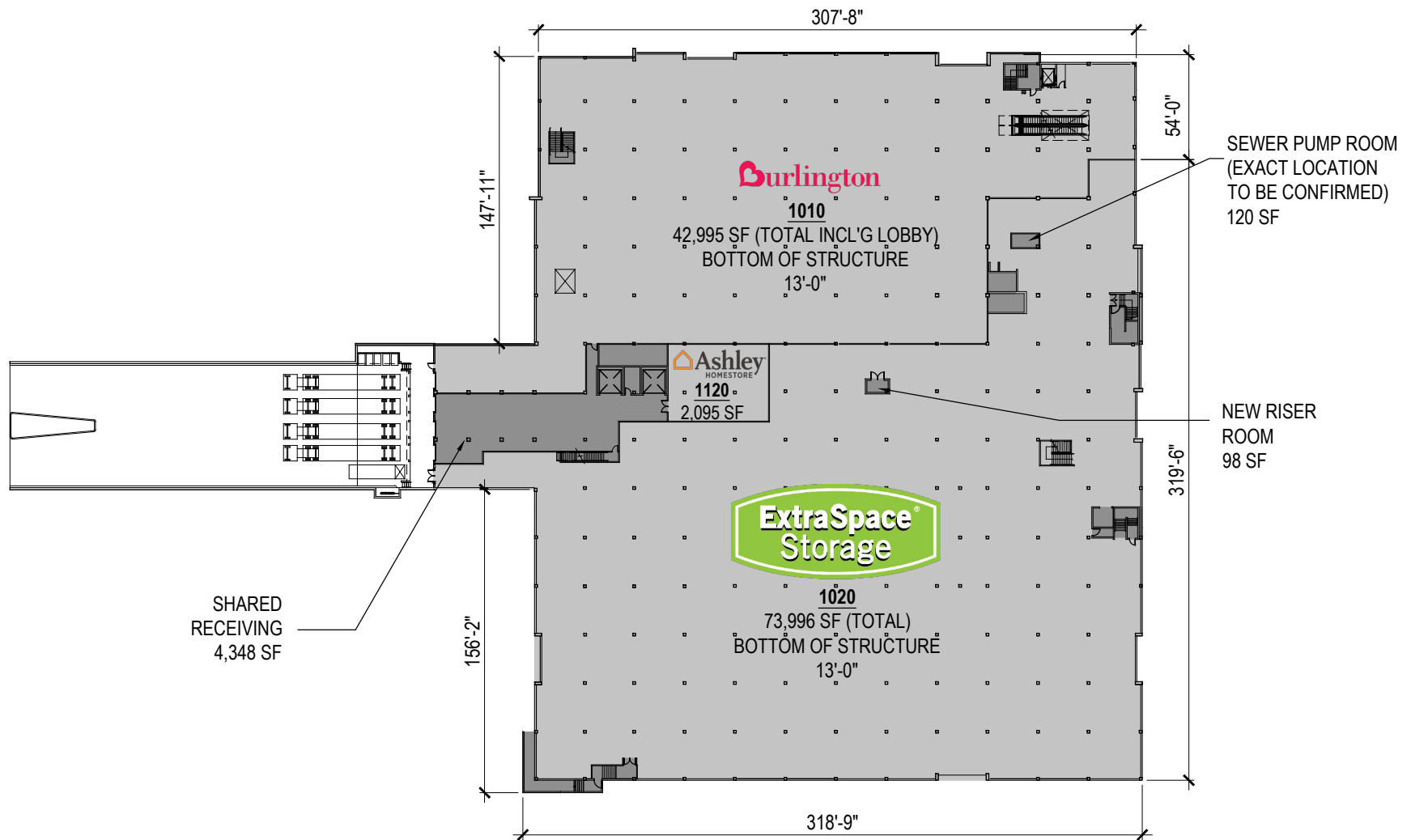

AVAILABLE
 LEASED

NOTE: THIS CONCEPTUAL SITE PLAN IS FOR PLANNING PURPOSES ONLY. SITE SPECIFIC INFORMATION SUCH AS EXISTING CONDITIONS, ZONING, PARKING, LANDSCAPE AND EGRESS REQUIREMENTS MUST BE VERIFIED BY ZONING ATTORNEY AND CODE CONSULTANT. LOCATIONS OF MECHANICAL SHAFTS ARE TO BE DETERMINED. STAIRS ARE FOR ILLUSTRATIVE PURPOSES ONLY AND TO BE REVISED TO MEET EGRESS REQUIREMENTS.



SCALE: 1" = 80'-0"



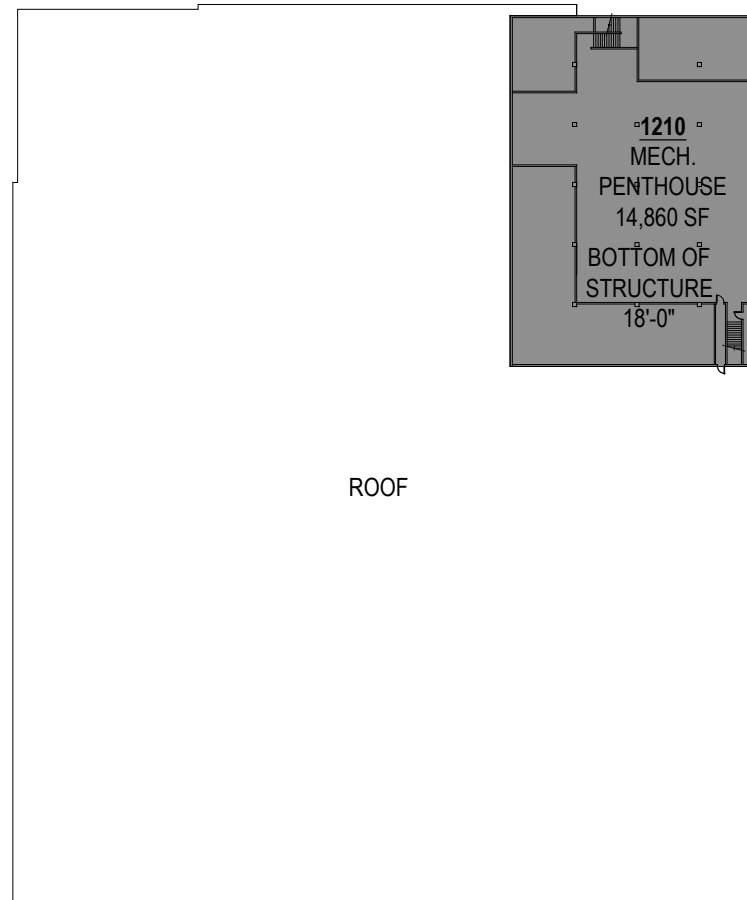

 AVAILABLE
  LEASED

NOTE: THIS CONCEPTUAL SITE PLAN IS FOR PLANNING PURPOSES ONLY. SITE SPECIFIC INFORMATION SUCH AS EXISTING CONDITIONS, ZONING, PARKING, LANDSCAPE AND EGRESS REQUIREMENTS MUST BE VERIFIED BY ZONING ATTORNEY AND CODE CONSULTANT. LOCATIONS OF MECHANICAL SHAFTS ARE TO BE DETERMINED. STAIRS ARE FOR ILLUSTRATIVE PURPOSES ONLY AND TO BE REVISED TO MEET EGRESS REQUIREMENTS.

0 20' 40' 80' 160'

SCALE: 1" = 80'-0"

